

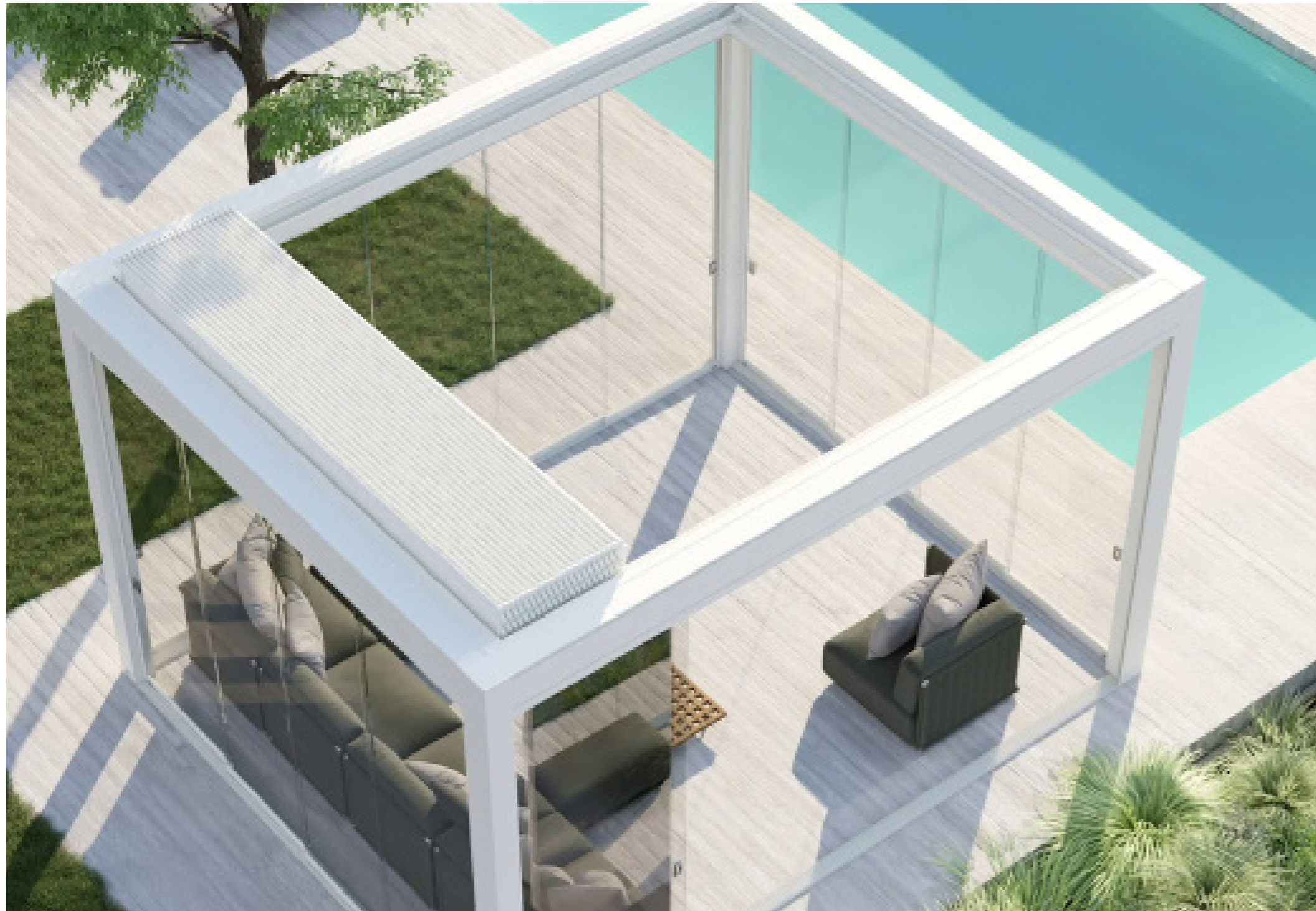

SPIRE-R

Bioclimatic Pergola

 **Euro Systems**[®]
Design with Passion



INTRODUCTION

The Spire-R is an aluminum pergola with a rotating louver-retractable roof system. The retractable, moveable blade roof allows light intensity and air ventilation to be adjusted. Louvers rotate and retract simultaneously with a single smooth movement, allowing for quick and easy adjustment of personal comfort at the touch of a button. Structure that differentiates itself for its endless modularity in width and projection, with no visible bolts and a clean aesthetic.



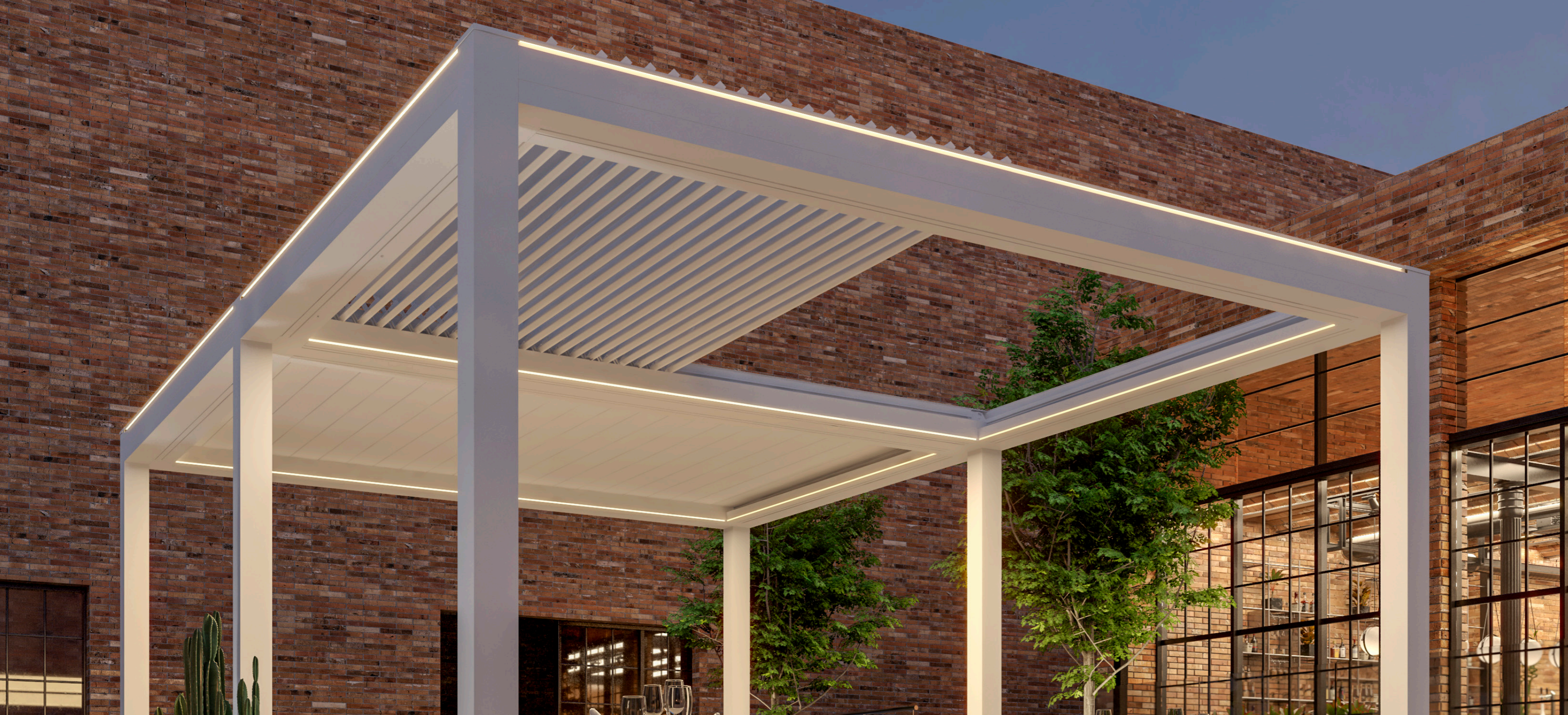

**Lavishly
Designed
to Create the
Best Outdoor
Experience**



Retractable
Folding and retractable blades system. The opening and closing blades rotate in a single movement. Maximum dimensions for single module W 450 P 611 cm .



Compacted Blades Dimensions:
28 blades - maximum overall dimensions 106 cm.



Moduler Systems
infinite number of modules can be installed side by side.



Illumination with LED strips external (rgb) and internal, blades.



Clousure
Possibility of side closures with vertical drop down blinds, sliding glass doors and draped curtains.



A gutter system allows draining of water through the columns. the louver blades have been designed to allow water draining along a built-in gutter, which work even when opening them..





LED LIGHTING

Lighting with LED strips along the internal and external perimeter.



MAXIMUM WATERTIGHTNESS

Water is carried through the pillars by a system of all-around gutters and drainage components. The louver blades have a built-in water drainage system.

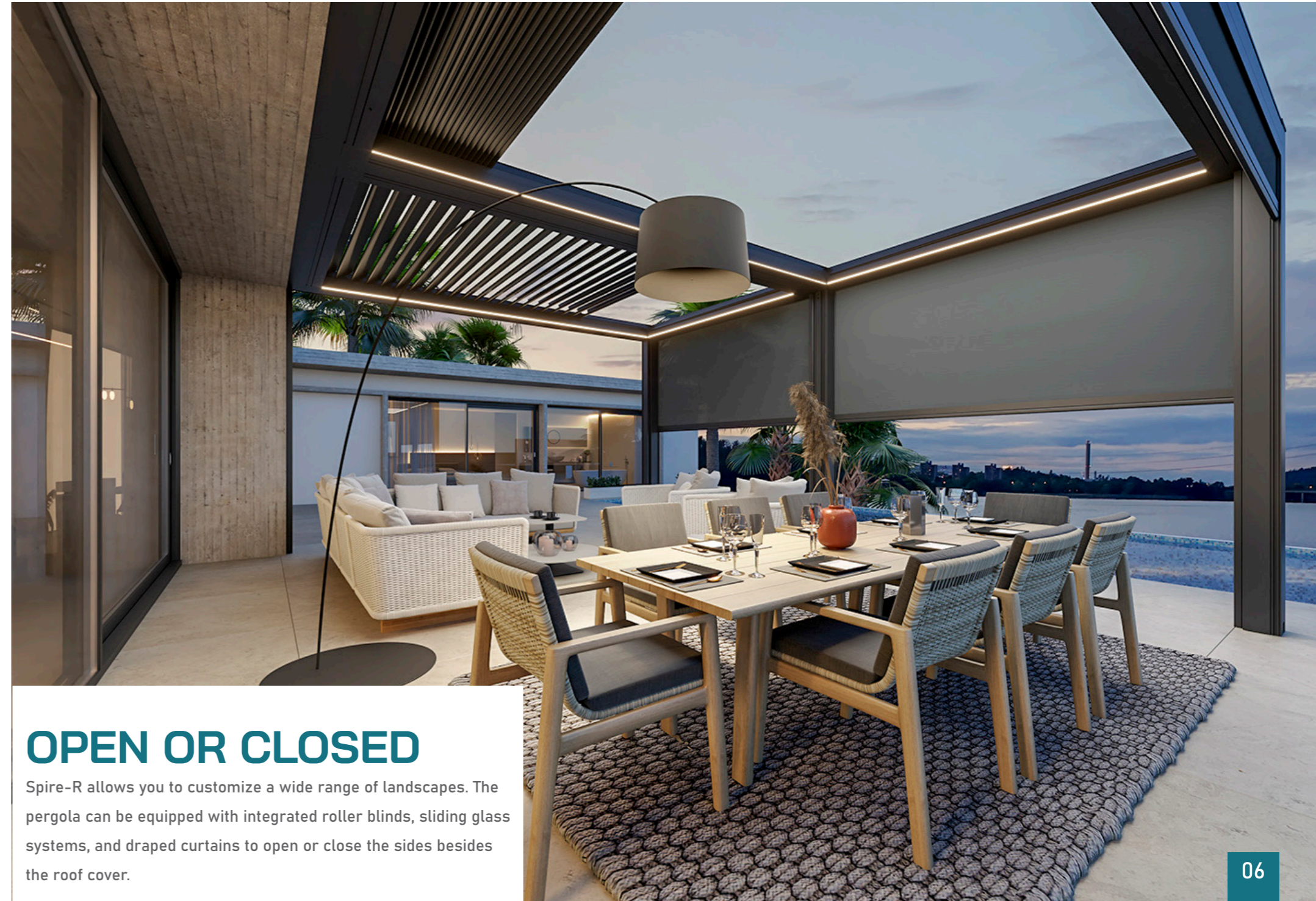

OPEN OR CLOSED

Spire-R allows you to customize a wide range of landscapes. The pergola can be equipped with integrated roller blinds, sliding glass systems, and draped curtains to open or close the sides besides the roof cover.



COMPACT SIZE

28 Louver blades in the maximum projection. Maximum size of stacked louver blades of 106,6 cm.

AUTOMATION

Spire-R modifies the underground space to any weather condition using a combination of last generation automatic weather sensors. (wind, rain, sun).



MODULAR SYSTEM

Attachable modules without limits of dimensions in width or projection.



INNOVATIVE SYSTEM

Retractable louver blades, stacked to one side. The louver blades rotate in a single movement closing and opening. Maximum dimensions for a single module: Width 450cm, Projection 611cm.

STANDARD COLORS

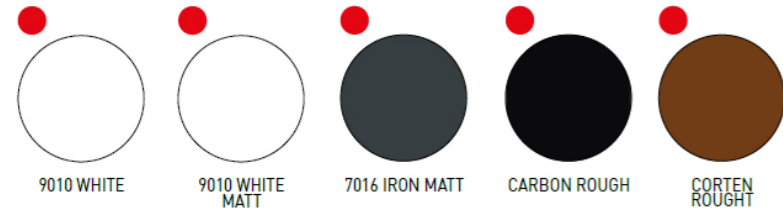

ADDITIONAL COLORS



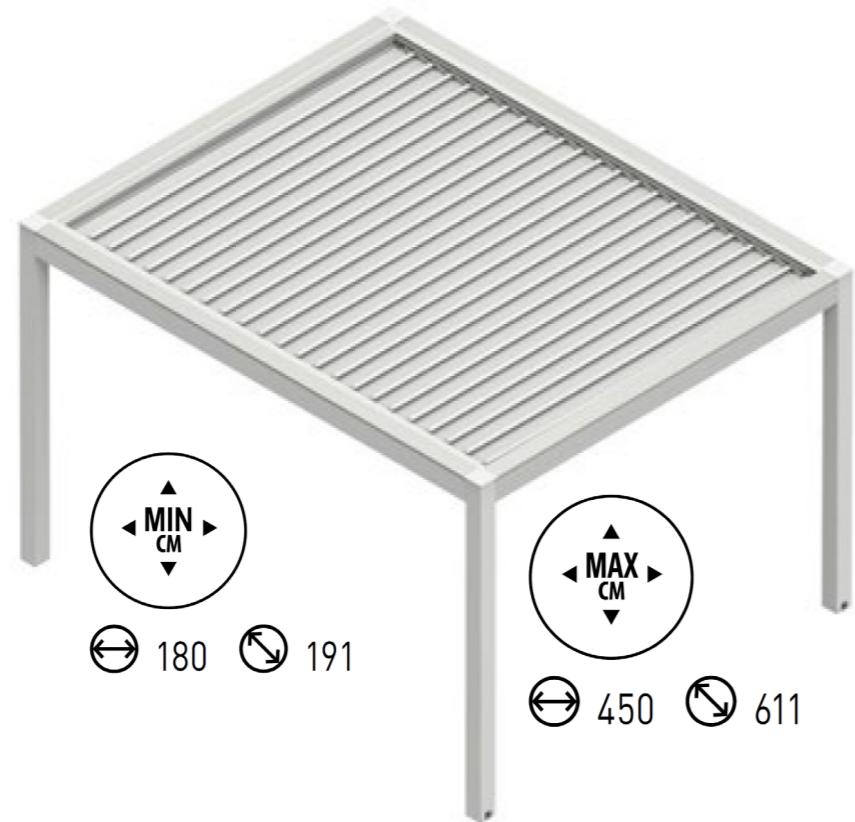

Self-supporting aluminium shade structure with a roof with adjustable blades consisting of a perimeter support beam and attached gutters that allow water to run off. movement is provided by tubular motors
 A structure that stands out for its unrestricted mobility in terms of width and depth with a "clean" look and no visible screws.
 Certified wind resistance up to class 6 according to EN 13561.

OPTIONAL

LIGHT



BLINDS



GLASS DOORS

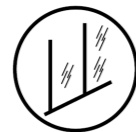

TECHNICAL INFORMATION

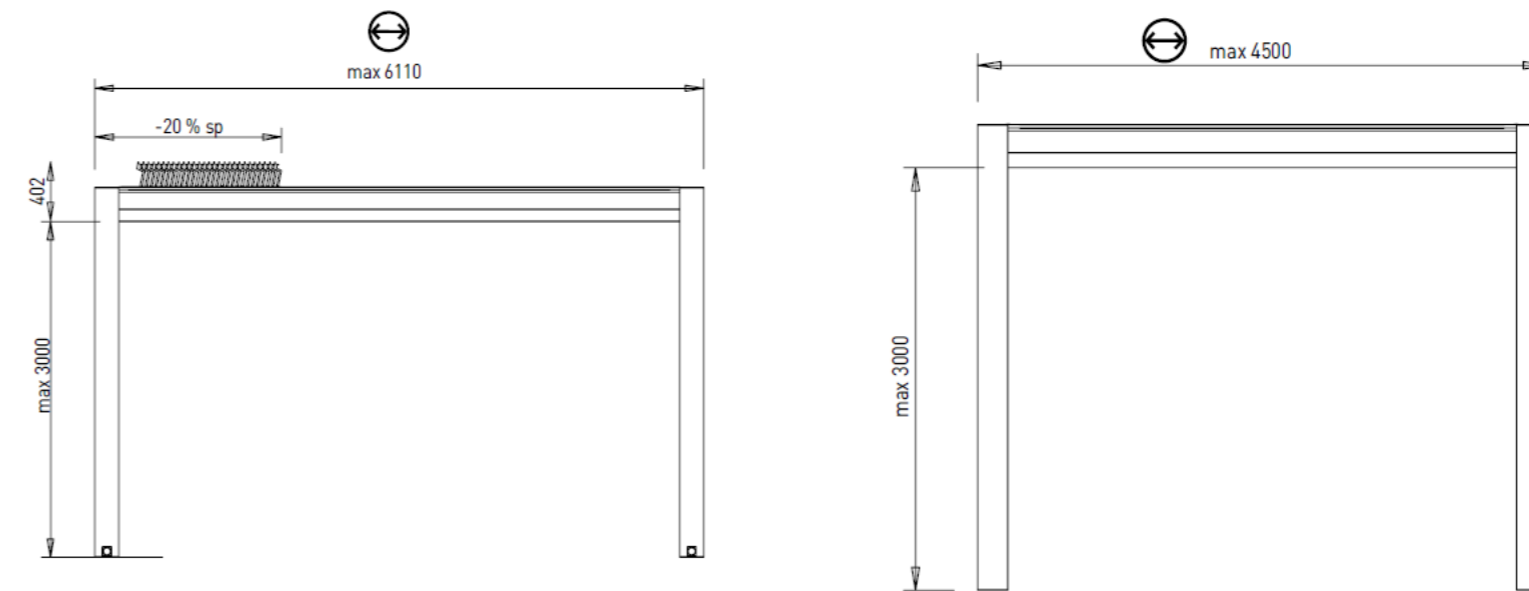

mandatory column beyond w.300 cm. and d.605 cm. for module

Profiles dimensions

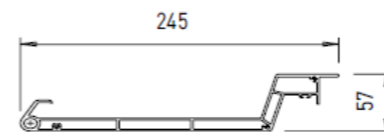

Louvre blade profile

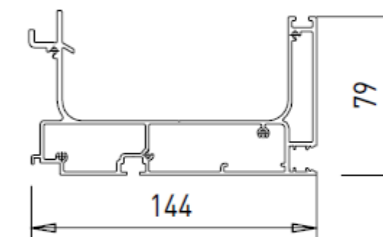
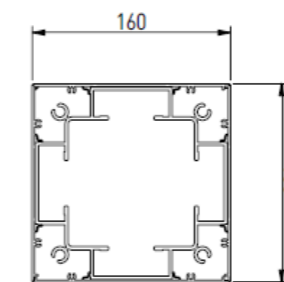

A Standard

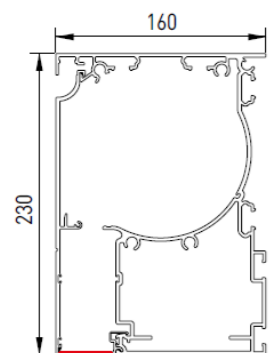

Ground Connection

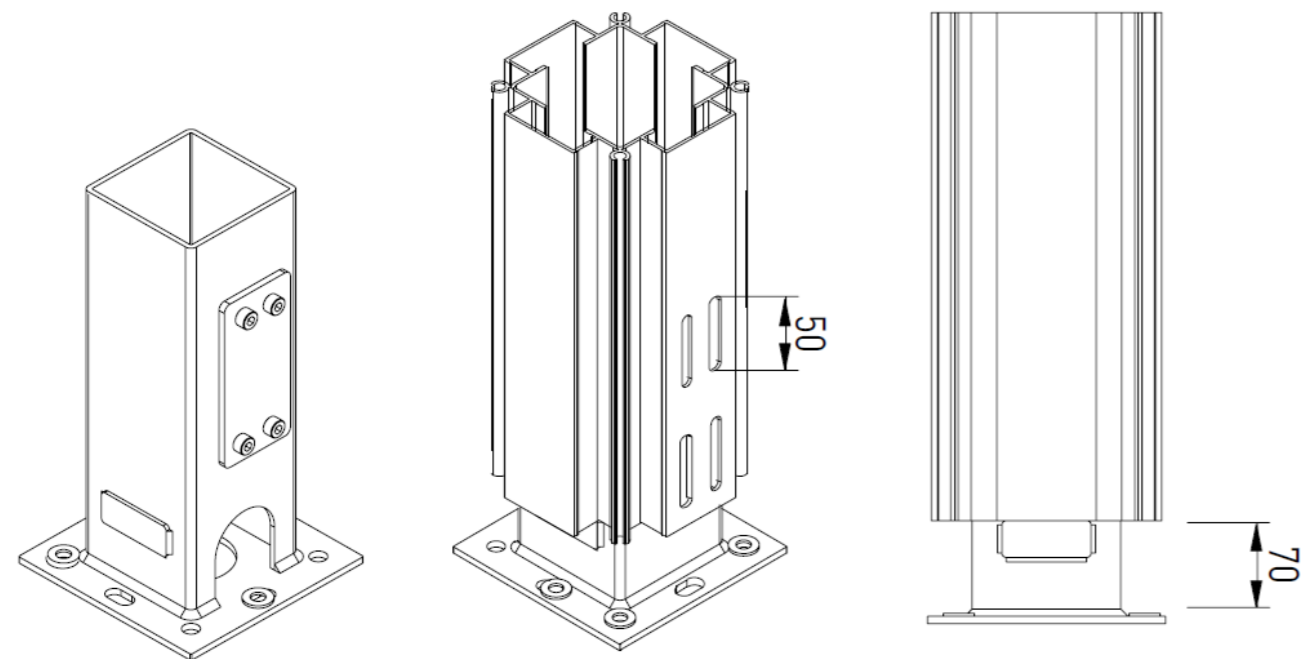

Wall Installation

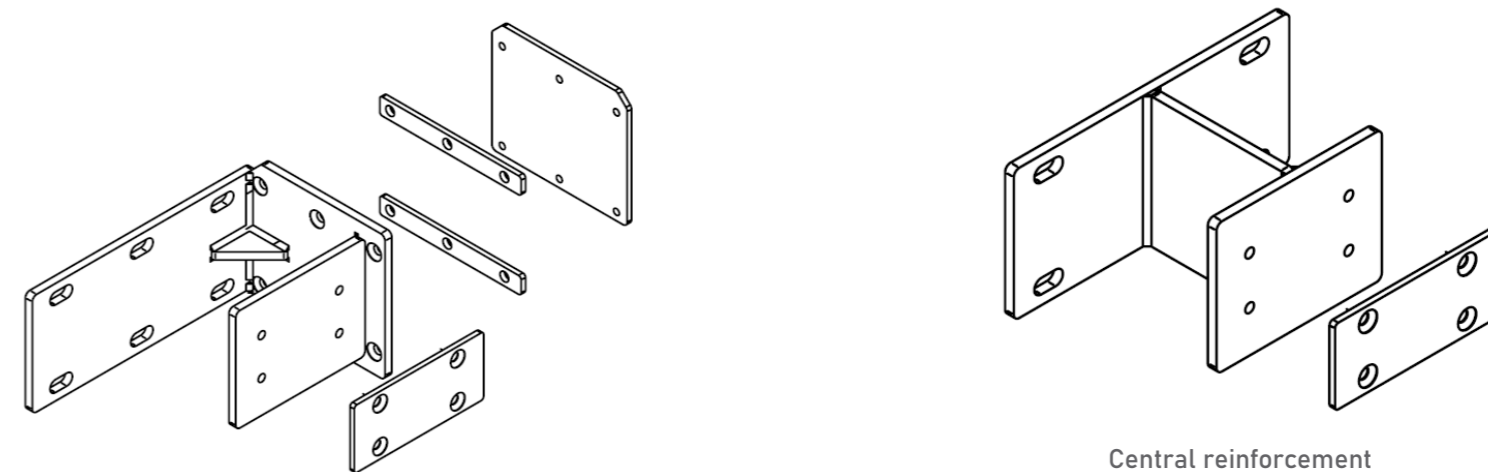

Central reinforcement
bracket for L.> 275

	N°Lame
211	8
231	9
251	10
271	11
291	12
311	13
331	14
351	15
371	16
391	17
411	18
431	19
451	20

	N°Lame
471	21
491	22
511	23
531	24
551	25
571	26
591	27
611	28

OPTIONAL LINE GLASS



- Sliding doors
- Easy installation with left or right hand opening.
- Concealed Drain System

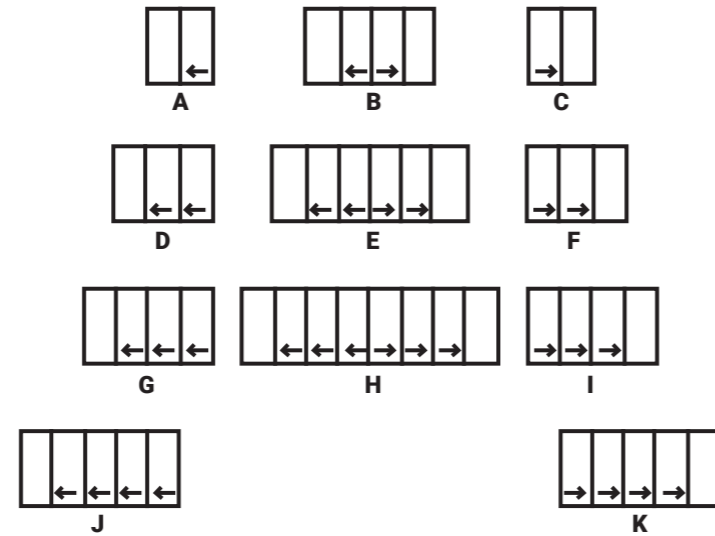

ROLLER BLINDS CONFIGURATION

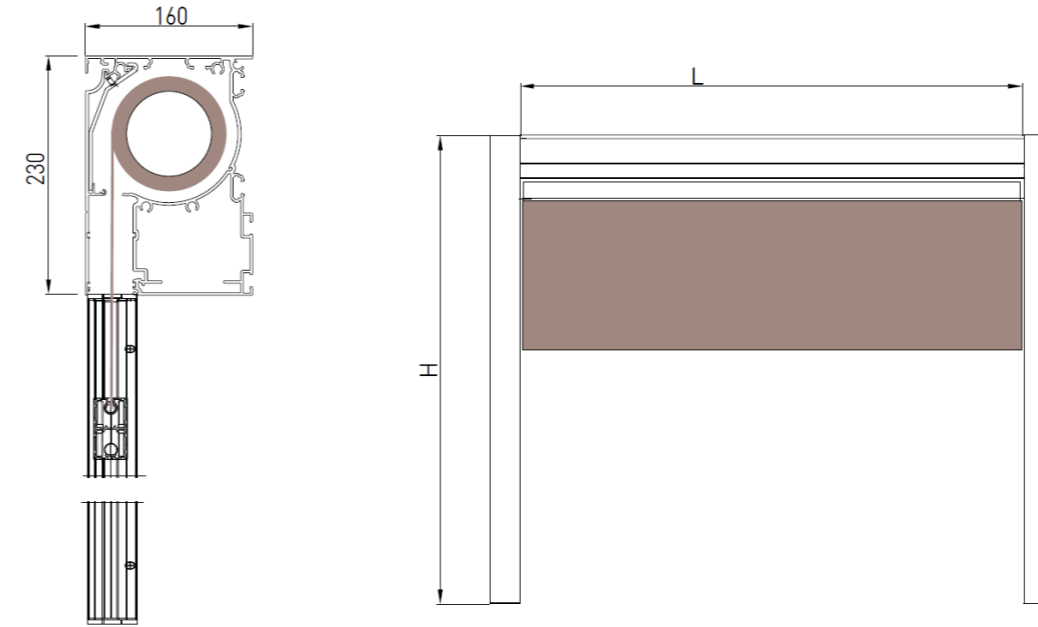

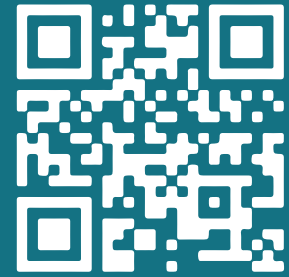
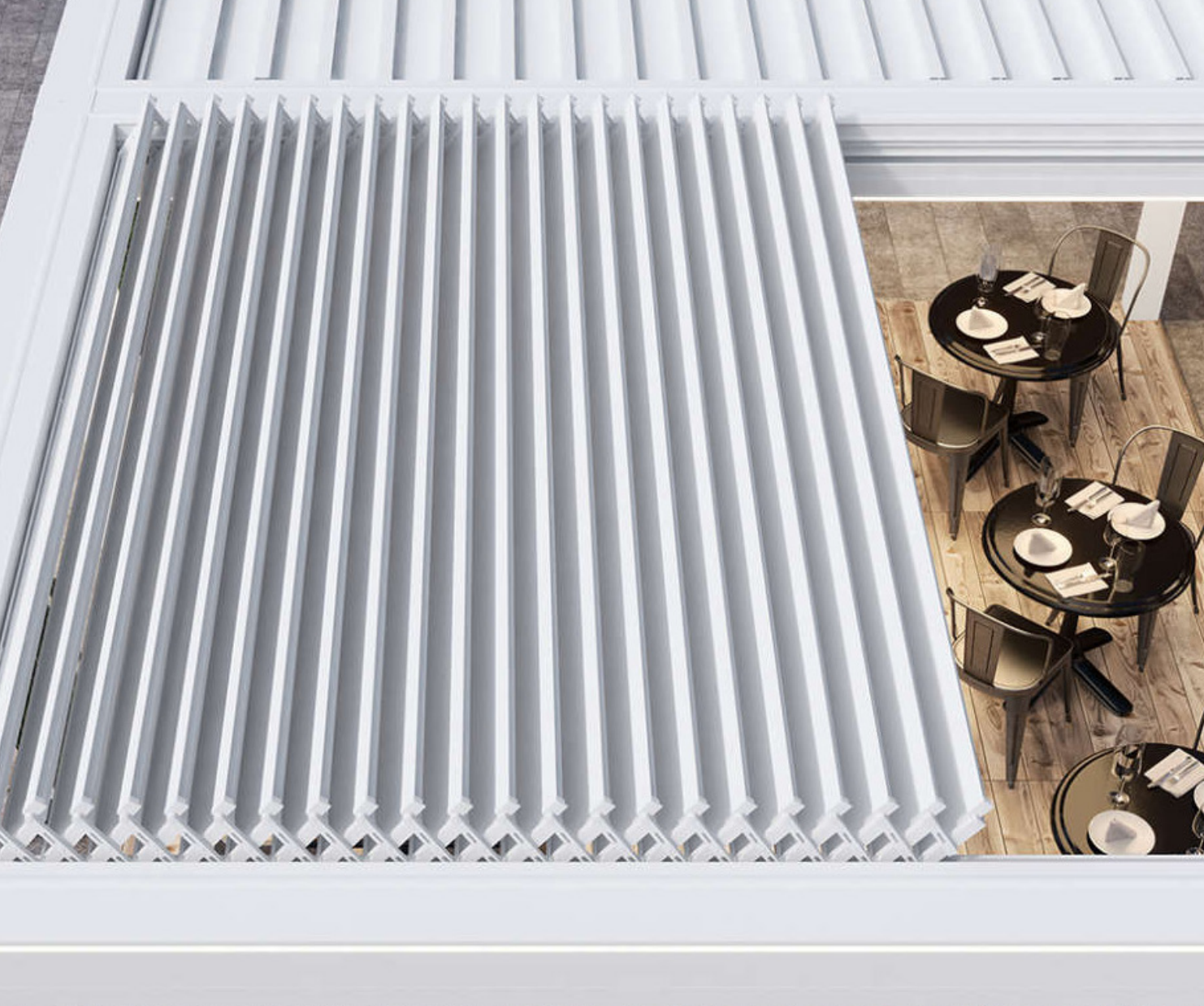

 **Euro Systems[®]**

Design with Passion

 info@eurosystems.com

 www.eurosystems.com

UK / UAE / QATAR / KSA